



Line #	Length	Direction
L1	60.106	N86° 21' 52.91"E
L2	46.185	N75° 53' 38.95"E
L3	555.184	S88° 46' 03.23"E
L4	159.238	S84° 48' 23.34"E
L5	976.280	S88° 46' 03.23"E
L6	292.980	S71° 04' 55.34"E
L7	774.542	S01° 13' 08.93"W
L8	183.227	S65° 49' 26.73"W
L9	183.802	S01° 12' 25.55"W
L10	42.377	S00° 52' 06.46"E

Curve #	Radius	Length	Chord Direction	Start Point	End Point
C1	177.899	33.093	N85° 43' 59.49"E	(995284.8342, 1950643.7299)	(995317.7861, 1950646.1884)
C2	582.000	173.482	S80° 13' 41.69"E	(997007.4826, 1950698.8349)	(997177.8151, 1950569.4998)
C3	162.000	204.427	S34° 55' 53.20"E	(997454.9693, 1950474.5116)	(997564.4100, 1950317.8155)
C4	362.000	408.180	S33° 31' 17.83"W	(997547.9304, 1949643.4484)	(997334.2657, 1949220.9007)
C5	262.000	295.478	S33° 30' 56.14"W	(997167.1092, 1949145.8620)	(997012.4667, 1948912.3606)
C6	855.443	31.351	S00° 10' 09.54"W	(997008.5947, 1948728.6000)	(997008.5020, 1948697.2509)

SHEET NOTES

- THE LAYOUT OF FACILITIES SHOWN ON THESE DRAWINGS ARE BASED ON THE HORIZONTAL AND VERTICAL CONTROL SYSTEM ESTABLISHED BY THE SURVEY. SEE SHEETS CV100 - CV103 FOR BENCHMARKS.
- SET AUXILIARY BENCHMARKS AS REQUIRED TO LAYOUT AND CONSTRUCT WORK.
- IN THE EVENT OF ANY DISCREPANCIES BETWEEN THESE CONTRACT DOCUMENTS AND THE ELECTRONIC FILES, THE CONTRACT DRAWINGS WILL CONTROL. NOTIFY THE ENGINEER IMMEDIATELY WHEN ANY DISCREPANCY IS NOTED.
- FIELD VERIFY ALL DIMENSIONS. REPORT ANY DISCREPANCIES TO THE ENGINEER IMMEDIATELY.
- MAKE ADJUSTMENTS TO THE LAYOUT AS DIRECTED BY THE ENGINEER TO ENSURE PROPER CONNECTION TO EXISTING FACILITIES AND SITE AMENITIES.
- CURB DIMENSIONS ARE TO BACK OF CURB, EDGE OF PAVEMENT, OR CENTERLINE OF ROAD, UNLESS OTHERWISE NOTED.
- PROPOSED CURBS TO BE FIELD STAKED FOR APPROVAL BY THE ENGINEER PRIOR TO INSTALLATION.
- PAVING RADII SHALL BE FORMED COMPLETELY AND SMOOTHLY TRANSITION INTO TANGENTS AND ADJOINING LINES. FLAT CURVE SEGMENTS IN HORIZONTAL LAYOUT SHALL BE REMOVED AND REPLACED AT NO COST TO OWNER.
- IN ADDITION TO THOSE SHOWN, EXPANSION JOINTS SHALL BE LOCATED AT ALL FIXED SITE ELEMENTS, I.E. WHERE PAVEMENT MEETS BUILDINGS, CURBS, UTILITIES, ETC.
- AN ELECTRONIC COPY OF AUTOCAD DRAWING FILES WILL BE PROVIDED FOR LAYOUT OF PROPOSED FACILITIES DESIGNED BY SMITHGROUP AND SHOULD BE USED ONLY FOR THOSE FACILITIES. NO GUARANTEE IS MADE BY SMITHGROUP FOR THE ACCURACY OF WORK PROVIDED BY OTHERS.

KEYED NOTES

- (A) BIKE PATH
- (B) EXISTING ASPHALT ROAD
- (C) PARKING LOT 1
- (D) CONCESSIONS BUILDING
- (E) PAVILION
- (F) MAINTENANCE BUILDING
- (G) FIELD 1
- (H) FIELD 2
- (I) STORMWATER MANAGEMENT AREA- BASIN A
- (J) CONCRETE WALKING PATH
- (K) ASPHALT WALKING PATH
- (L) EXISTING ASPHALT ROAD
- (M) EXISTING PARKING LOT
- (N) STORMWATER MANAGEMENT AREA- BASIN B

LEGEND

- PROPERTY LINE
- EASEMENT
- LIMIT OF CONSTRUCTION
- MEDIUM DUTY ASPHALT PAVEMENT
- LIGHT DUTY ASPHALT PAVEMENT
- HEAVY DUTY INTEGRAL COLORED CONCRETE PAVEMENT
- HEAVY DUTY CONCRETE PAVEMENT
- CONCRETE PAVEMENT
- GRAVEL SHOULDER
- TURF
- ADA TACTILE WARNING
- CONTROL JOINT
- ISOLATION (EXPANSION) JOINT
- CONCRETE TURNDOWN
- STANDARD CURB AND GUTTER
- RETAINING WALL
- CHAIN LINK FENCE
- BACKSTOP NET
- POST AND CHAIN
- GUARDRAIL
- 6FT MASONRY DUMPSTER ENCLOSURE
- WOOD BENCH ON CONCRETE PAD WITH PLINTH
- FLAGPOLES
- ROADWAY LIGHT POLE (SEE ELECTRICAL)
- PARKING LOT LIGHT POLE (SEE ELECTRICAL)
- SPORTS FIELD LIGHT POLE (SEE ELECTRICAL)
- LIGHT POLE (SEE ELECTRICAL)
- REMOVABLE BOLLARDS, TYP.
- BOLLARDS, TYP.

ELGIN SPORTS COMPLEX EXPANSION
475 Sports Way,
Elgin, Illinois 60123

VOLUME 1 OF 2



SMITHGROUP
35 EAST WACKER
SUITE 900
CHICAGO, IL 60601
312.641.0770
www.smithgroup.com

HPZS
314 W INSTITUTE PL
SUITE 1E
CHICAGO, IL 60610
312.944.9600
www.hpzs.com

ISSUED FOR	REV	DATE
ISSUE FOR BID	1	04/11/2024

SEALS AND SIGNATURES

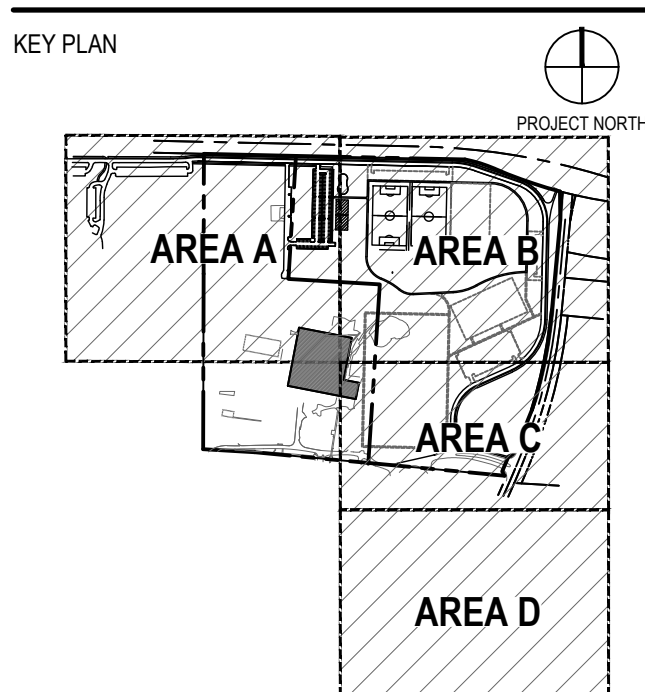

DRAWING TITLE
SPORTS WAY PLAN AND PROFILE

SCALE: 1" = 150'

SCALE 14106
PROJECT NUMBER
DRAWING NUMBER

CS-300

CALL J.U.L.I.E.
1-800-892-0123
48 Hours (2 working days) Before You Dig.

FILE: C:\Users\jvanderk\OneDrive\Documents\Projects\Elgin Sports Way\CS-300.dwg DATE: Apr 11, 2024 TIME: 09:59 am

